



MYSTIC SOUL



LOA:	52' (15.85m)	Delivery/Model	2019
Beam:	22' (6.71m)	Year:	
Max Draft:	4' 8" (1.42m)	Model:	PC52
Clearance:	25' (7.62m)	Builder:	HORIZON
Tonnage:	34.00	Type:	Catamaran Cruiser
Speed:	18 Knots 21 Knots	Staterooms:	3
Flag:	CAYMAN	Fuel Cap:	975 Gal
Location:	N/A, Florida United States	Water Cap:	250 Gal
VAT Paid:	US Duty Paid	Engines:	2x, Cummins, QSB 6.7, 550 HP
		Price:	\$1,895,000 USD

The Powercat Company LLC
2525 Marina Bay Drive West
Suite 202
Fort Lauderdale Florida
33312 United States

Jason Ford
M: (954) 552-0868
jason@powercatco.com
www.horizonpowercatamarans.com

MYSTIC SOUL

Additional Specifications For MYSTIC SOUL:

LOA:	52' (15.85m)	Delivery/Model	2019
Beam:	22' (6.71m)	Year:	
Min Draft:	4' 4" (1.32m)	Year Built:	2018
Max Draft:	4' 8" (1.42m)	Builder:	HORIZON
Hull Material:	Advanced Composites	Model:	PC52
Superstructure:	GRP	Type:	Catamaran Cruiser
Hull Config:	Catamaran	Top:	Hardtop
Hull Designer:	Angelo Lavranos	Engines:	550 HP, Twin, 2018, Inboard, Diesel, Cummins, QSB 6.7, 1540hrs / 1540hrs
Deck Material:	Composite Fiberglass	Staterooms:	3
Tonnage:	34.00	Sleeps:	6
Range At Cruise	400	Heads:	2
Speed:		Captain Cabin:	No
Range At Max	300	Classifications:	
Speed:	Cruising 18 Knots	MCA: ISM:	
	Max 21 Knots		
Int Designer:	LEIGH FORD		
Ext Designer:	JC Espinosa		
Fuel Capacity:	975 Gal		
Water Capacity:	250 Gal		
Holding Tank:	80 Gal		
Flag:	CAYMAN		
Location:	N/A, Florida United States		
Price:	\$1,895,000 USD		
Tax Status:	US Duty Paid		

WELCOME ABOARD MYSTIC SOUL

A. Hull and Main Structure:

1. White Gelcoat finish for hull above water line, exterior deck and superstructure.
2. One-piece hull lamination and longitudinal girders
3. Hull is built with licensed process SCRIMP™ for improved strength and less weight
4. High density foam cored construction bottom and topsides
5. Solid fiberglass laminate stem & keel.
6. Main Engine girders with high density foam coring
7. Deck & superstructure foam cored reinforcement for rigidity
8. International anti-fouling bottom paint, w/ anti-osmosis treatment

B. Exterior Deck and Equipments:

1. Nonskid main deck, with Synthetic Plasdeck in Cockpit and Stairs
2. Fiberglass cap rail.
3. S/S rub rail around hull deck joint.
4. Heavy-duty S/S #316 1-1/4" handrail w/1"(stanchions)
5. 10 Stainless Mooring cleats on deck.
6. Flag staff on back of flybridge.
7. Fuel and water inlets, Black water Pump outs on deck.

Mooring System

1. Locker for 24V anchor windlass.
2. 50KG Delta anchor.
3. 200ft of high tensile 3/8" chain and 150ft warp.
4. Deck switches for anchor windlass.
5. Custom Bridle and chain hook with Leather Chafe guards

Doors, Hatches, Windows & Port Holes

1. SS sliding salon door.
2. Two bow storage lockers with access through flush FRP deck hatches.
3. 4 x Deck hatches with blinds & screens.
4. Engine access through manual deck hatches in cockpit floor with manual struts.
5. Two large hull side frameless window.
6. Six oval portholes.

Aft Deck Area

1. Curved seat with Sunbrella cushions and Sunbrella covers.
2. Hi Gloss dual position Teak cockpit table. With 4 chairs
3. Corian Bar Counter with Sink, Fridge and Scotsman Ice Maker.
4. Synthetic Plasdeck with white Lines
5. Two steps down to dive/swim platform.
6. Cockpit lockers for storage.
7. 2 side boarding doors
8. S/S transom door with Horizon Logo
9. Dimmer switch for Aft. deck ceiling lighting
10. 5 x Burnewiin Rod Holder system
11. Drop shade Sun Screen for aft deck

Swimming Platform Area

1. Built-in shower with hot/cold water.
2. City water inlet

The Powercat Company LLC
2525 Marina Bay Drive West
Suite 202
Fort Lauderdale Florida
33312 United States

Jason Ford
M: (954) 552-0868
jason@powercatco.com
www.horizonpowercatamarans.com

MYSTIC SOUL

3. Swim ladder on STBD side.
4. Synthetic Plasdeck on Swim Platforms
5. S/S safety rail on swim platform

Lights

1. LED courtesy lights around decks and Flybridge.
2. LED bulwark w/ flush mounted deck lights
3. LED ceiling lights
4. Stainless and acrylic Lighted boat name on transom.
5. AQUA SIGNAL navigation lights.
6. Cockpit down lights.

C. Flybridge:

1. Non-skid flybridge cambered deck with ample drainage.
2. Stainless removable railing on Boat Deck
3. Airconditioned Flybridge with Dual adjustable Vents
4. Three Glass panes with Center Washer and Wiper with V-Kool
5. SeaCrylic enclosures for sides and back with Zip up Doors and Windows.
6. Chocks for Dinghy
7. Hatch on Hard Top
8. Helm station with stainless wheel and instrument console.
9. Washdown Faucet on Flybridge
10. Single STIDD helm chair
11. FRP Arch & FRP Hardtop.
12. Sink, with hot and cold water.
13. Dometic fridge in bar.
14. Corian table with 4 seating.
15. Sunning bed/ Bench Seat stb side of helm console with cushions
16. Ample locker space for storage.
17. E1000 Full function Hydraulic Crane.
18. Dimmer switch for F/B ceiling lighting
19. Custom Infinity Carpet

D. Flybridge Instruments:

1. Controls for ship's horn.
2. Bilge pump monitor Panel and control on F/B helm station.
3. Ritchie 4-1/2" compass.
4. Monitoring system for tanks (fuel, fresh water, black water)
5. 2 x 7616 Garmin Displays
6. Chirp Fishfinder Transducer
7. Garmin Wind Indicator.
8. Garmin 48 Mile High Def Radar
9. Fusion IP700 with Amp Sub Woofer and 4 speakers on Flybridge, 2 on aft Deck, 2 on Bow.
10. Windlass Controls
11. Spot Light
12. 5 Function remote DOCKMATE
13. 4 x Solar Panels on Hardtop

E. Electrical system:

1. Color-coded wiring for easy identification.
2. Extensive Manuals and Wiring diagrams
3. Premium DC distribution board with switches, voltmeter and amp meter.
4. Outlets in Salon / bar / galley / cabins / fly-bridge / aft deck / engine room.

5. Vimar switches for lights and electrical outlets.

AC/DC Main Power System

1. AC power supply from 17kw Onan generator / shore power.
2. Selector switch for AC power supply.
3. Remote panel for generator.
4. Four AGM Batteries for engine & generator start up.
5. Four AGM Batteries for ship's service power.
6. BEP battery switch.
7. One 100amp battery charger with three outputs.
8. One inverter 3.0 KW.
9. Premium AC panel with switches

Shore Power System

1. One shore power 50Amp connector on a 70ft Glendenning Cablemaster.
2. One Extra 50Amp connection with 50ft Cord

G. Mechanical system:

Fuel and Lube Oil System

1. Dual Backlit Racor filter for engines and Generator.
2. Dual oil change pump for engines, generator and Gearboxes.

Fresh Water System

1. 270 Gal of water tank integral to hull.
2. 24v Spectra 700 Gal/day Watermaker
3. Color coded piping for easy identification.
4. Marine grade lines for fresh water system
5. One 17 Gal/110V water heater.
6. 2 x High volume 24V fresh water pump with accumulator tank.
7. Fresh water washdown for anchor.
8. Fresh Water Washdown on Aft Deck.
9. Extra 175gal fuel tank (with extra fuel transfer pump and gauge)

Sanitary System

1. 2 x 40 Gal of holding tank integral to hull
2. Headhunter Electric fresh water flush toilets, pumps with Y valve for automatic discharge. and dock side pump out (2).

Bilge Water System

1. 4x electric 24V bilge pumps.
2. High level bilge water alarm.

Fire Safety System

1. One Seafire automatic/manual fire extinguisher in engine room.

Air Conditioning System

1. Marine Air –central air conditioning for each cabins and salon.
2. Air Cond. Self cleaning system

H. Interior Design and Equipment:

Interior Finish

1. Wood flooring with Carpet in Cabins.
2. Tempered safety glass windows.
3. Soft furnishings including roman blinds and accent wood finishing.

Heads and Showers General

1. Wood floor.
2. Corian countertops.
3. Custom Mother of Pearl backsplashes
4. Fabric blind over large window.
5. Portlights for ventilation.
6. Basin, cabinets and mirrors.
7. Walk-in separate shower.
8. Linen Cupboard inboard of the M/S shower.
9. Separate toilet.
10. Lights in Overhead.
11. Extractor fan.

Salon

1. Salon seating covered infabric.
2. Hi-Lo High Gloss Wood dining table.
3. High Gloss Burl countertoos
4. Cabinet for drinks glasses.
5. Samsung TV wit Sonos Soundbar
6. Leatherette Barrel Chair with Ottoman
7. Two hatches with screen on top of salon roof
8. Pleated Blinds

Galley

1. Wood floor.
2. Corian counter tops.
3. Double sinks with Faucet and sink disposal.
4. Custom accent wood carpentry.
5. Custom wooden carpentry for galley, cupboards and counters.
6. 3 x Custom pull out Stainless stools at Galley counter
7. Cutlery & crockery drawers.
8. Pot drawer & spice drawers.
9. Additional storage drawers and cupboards.
10. Under counter trash drawer.
11. Miele Fridge and Freezer Drawers
12. Fisher Paykel Dishwasher Drawer
13. GE Avantium Oven and Microwave
14. Electric 4 burner Induction Cooktop
15. Extractor Fan above cooktop

VIP stateroom:

1. Queen bed, semi walk around.
2. Closets.
3. Custom wood accent carpentry.

4. Carpeted floor
5. Deck hatch with screen & opening.
6. Fabric blind over large window.
7. Soft furnishings.
8. Night stands with light switches and outlets.

Port Aft guest stateroom:

1. Custom wood accent carpentry.
2. Carpeted floor.
3. Insert to make Twin into Queen
4. Opening port lights in hull side.
5. Soft furnishings.
6. Storage beneath beds.
7. Cabin lights.
8. Shared bathroom with VIP cabin.

Master Stateroom

1. Custom carpentry for accent finishing.
2. Carpeted floor.
3. High Gloss Walnut Shiplap feature
4. Deck hatch with screen.
5. Roman blinds over large window
6. Queen size bed, semi walk around.
7. Large full height closets.
8. Closets for linens / towels and clothes.
9. Cabin lights.
10. Night stands with light switches and outlets.

Extras

1. 13ft AB Tender with 60H.P. Yamaha
2. Foredeck Cushions with Covers
3. Full set of Tools, Cleaning Products

Shakespeare Cell Booster

AT ANCHOR1



AT ANCHOR4



The Powercat Company LLC
2525 Marina Bay Drive West
Suite 202
Fort Lauderdale Florida
33312 United States

Jason Ford
M: (954) 552-0868
jason@powercatco.com
www.horizonpowercatamarans.com

MYSTIC SOUL

AT ANCHOR3



AT ANCHOR2



The Powercat Company LLC
2525 Marina Bay Drive West
Suite 202
Fort Lauderdale Florida
33312 United States

Jason Ford
M: (954) 552-0868
jason@powercatco.com
www.horizonpowercatamarans.com

MYSTIC SOUL

FLYBRIDGE 1

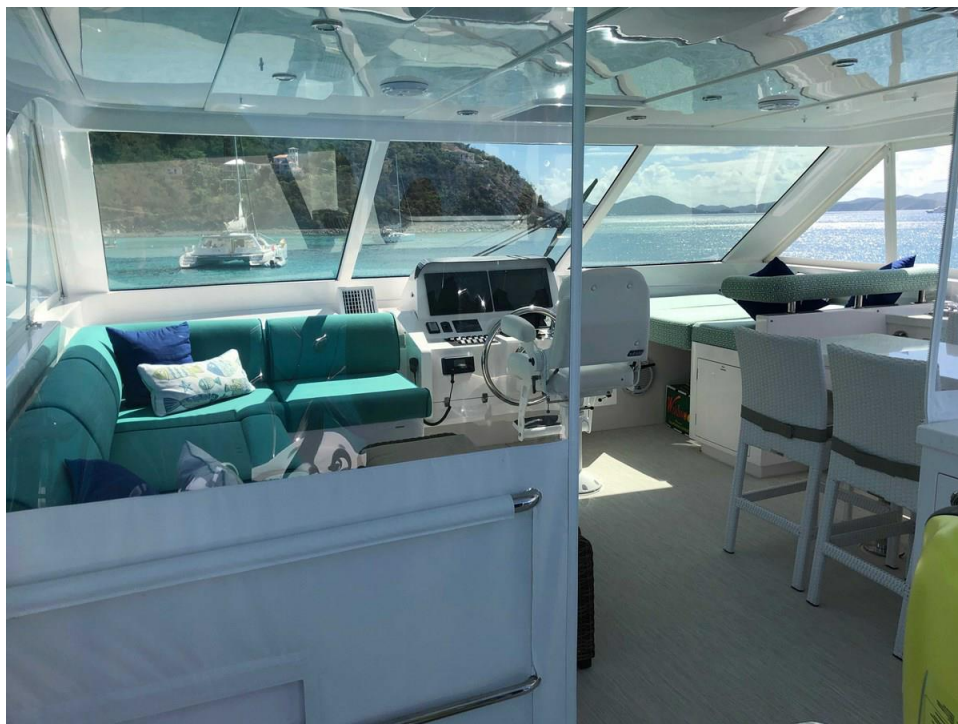

HELM



The Powercat Company LLC
2525 Marina Bay Drive West
Suite 202
Fort Lauderdale Florida
33312 United States

Jason Ford
M: (954) 552-0868
jason@powercatco.com
www.horizonpowercatamarans.com

MYSTIC SOUL

Controls



DINGHY



The Powercat Company LLC
2525 Marina Bay Drive West
Suite 202
Fort Lauderdale Florida
33312 United States

Jason Ford
M: (954) 552-0868
jason@powercatco.com
www.horizonpowercatamarans.com

MYSTIC SOUL

Salon 1



Salon 2



The Powercat Company LLC
2525 Marina Bay Drive West
Suite 202
Fort Lauderdale Florida
33312 United States

Jason Ford
M: (954) 552-0868
jason@powercatco.com
www.horizonpowercatamarans.com

MYSTIC SOUL

Salon 3



Master



The Powercat Company LLC
2525 Marina Bay Drive West
Suite 202
Fort Lauderdale Florida
33312 United States

Jason Ford
M: (954) 552-0868
jason@powercatco.com
www.horizonpowercatamarans.com

MYSTIC SOUL

Master Bathroom



VIP Cabin



The Powercat Company LLC
2525 Marina Bay Drive West
Suite 202
Fort Lauderdale Florida
33312 United States

Jason Ford
M: (954) 552-0868
jason@powercatco.com
www.horizonpowercatamarans.com

MYSTIC SOUL

Twin Cabin



PROFILE



 **HORIZON**
PC52 OPEN FLYBRIDGE

The Powercat Company LLC
2525 Marina Bay Drive West
Suite 202
Fort Lauderdale Florida
33312 United States

Jason Ford
M: (954) 552-0868
jason@powercatco.com
www.horizonpowercatamarans.com

MYSTIC SOUL

Flybridge Layout

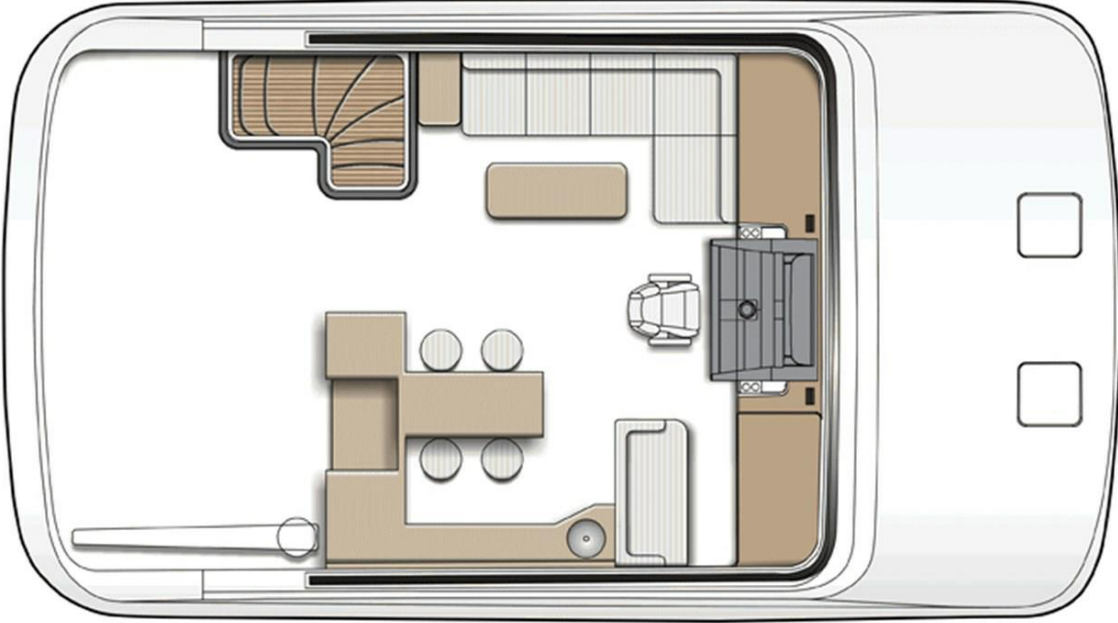

Lower Deck Layout

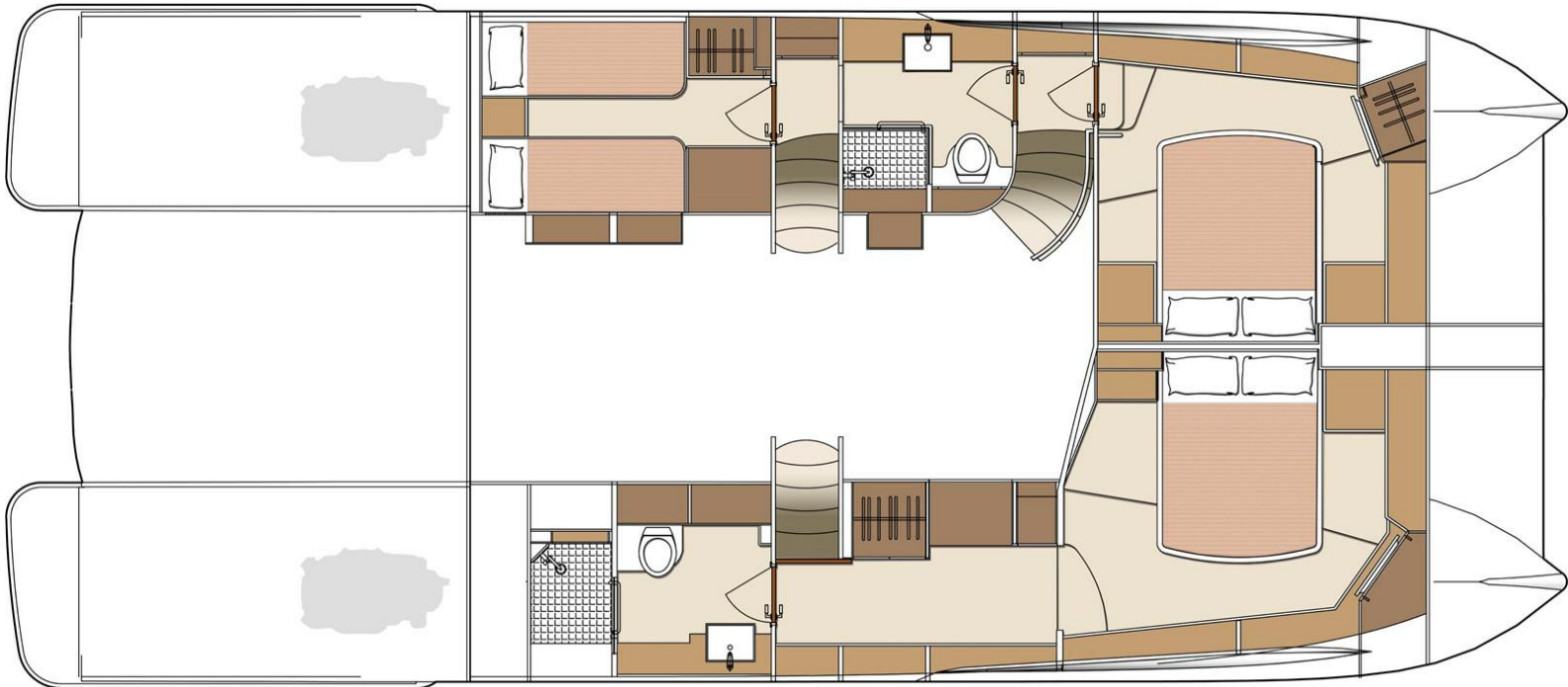

The Powercat Company LLC
2525 Marina Bay Drive West
Suite 202
Fort Lauderdale Florida
33312 United States

Jason Ford
M: (954) 552-0868
jason@powercatco.com
www.horizonpowercatamarans.com

MYSTIC SOUL

Main Deck Layout



The Powercat Company LLC
2525 Marina Bay Drive West
Suite 202
Fort Lauderdale Florida
33312 United States

Jason Ford
M: (954) 552-0868
jason@powercatco.com
www.horizonpowercatamarans.com

MYSTIC SOUL