



## CUT AND RUN



### 2015 HORIZON PC52

**LOA:** 52' (15.85m)  
**Beam:** 22' (6.71m)  
**Min Draft:** 4' 4" (1.32m)  
**Max Draft:** 4' 8" (1.42m)  
**Speed:** Cruising 18 Knots  
Max 22 Knots  
**VAT Paid:** US Duty Paid

**Build/Model Year:** 2014 / 2015  
**Builder:** HORIZON  
**Type:** Catamaran  
Cruiser  
**Price:** \$1,725,000 USD  
**Location:** Fort Lauderdale, Florida  
United States

### Additional Specifications For CUT AND RUN:

<b>LOA:</b>	52' (15.85m)	<b>Delivery/Model</b>	2015
<b>Beam:</b>	22' (6.71m)	<b>Year:</b>	
<b>Min Draft:</b>	4' 4" (1.32m)	<b>Year Built:</b>	2014
<b>Max Draft:</b>	4' 8" (1.42m)	<b>Builder:</b>	HORIZON
<b>Hull Material:</b>	Advanced Composites	<b>Model:</b>	PC52
<b>Hull Config:</b>	Catamaran	<b>Type:</b>	Catamaran Cruiser
<b>Hull Designer:</b>	ANGELO LAVRANOS	<b>Top:</b>	Hardtop
<b>Deck Material:</b>	Composite Fiberglass	<b>Engines:</b>	550 HP,Twin, 2014, Inboard, Diesel, Cummins, QSB 6.7, 1240hrs / 1240hrs
<b>Tonnage:</b>	32.00		
<b>Range At Cruise</b>	400	<b>Staterooms:</b>	3
<b>Speed:</b>		<b>Sleeps:</b>	6
<b>Range At Max</b>	300	<b>Heads:</b>	2
<b>Speed:</b>		<b>Captain Cabin:</b>	No
	Cruising 18 Knots	<b>Classifications:</b>	
	Max 22 Knots	<b>MCA: ISM:</b>	
<b>Int Designer:</b>	LEIGH FORD		
<b>Fuel Capacity:</b>	970 Gal		
<b>Water Capacity:</b>	250 Gal		
<b>Holding Tank:</b>	60 Gal		
<b>Flag:</b>	US		
<b>Location:</b>	Fort Lauderdale, Florida United States		
<b>Price:</b>	\$1,725,000 USD		
<b>Tax Status:</b>	US Duty Paid		

## **SPECIFICATIONS**

### **A. Hull and Main Structure:**

1. White Gelcoat finish for hull above water line, exterior deck, furniture and superstructure.
2. One-piece hull lamination and longitudinal girders
3. Hull is built with licensed process SCRIMP™ for improved strength and less weight
4. High density foam cored construction bottom and topsides
5. Solid fiberglass laminate stem, keel.
6. Main Engine girders with high density foam coring
7. Deck & superstructure foam cored reinforcement for rigidity
8. International anti-fouling bottom paint, w/ anti-osmosis treatment **NEW OCT 2022**

### **B. Exterior Deck and Equipment:**

1. Nonskid main deck
2. Teak covered aft deck & Steps.
3. Fiberglass cap rail.
4. S/S rub rail around hull deck joint.
5. Heavy-duty S/S #316 1-1/4" handrail w/1"( stanchions)
6. 10 Mooring cleats on deck.
7. Flag staff on back of flybridge.
8. Fuel and water inlets.
9. Locker for 24V anchor windlass.
10. 50KG DELTA anchor.
11. 150ft of high tensile 3/8" chain and 150ft warp.
12. Roller for anchor.

#### **Doors, Hatches, Windows & Port Holes**

13. SS sliding salon door.
14. Two bow storage lockers with access through flush FRP deck hatches.
15. 2 x Deck hatches with blinds & screens.
16. Engine access through manual deck hatches in cockpit floor with manual struts.
17. Two large hull side frameless window.
18. Six oval portholes.

#### **Aft Deck Area**

19. FRP Curved seat with cushions at aft. deck.
20. Teak cockpit table.
21. Aft Deck BAr with Fridge and Scotsman Icemaker **NEW 2023**
22. Comfortable stairs from aft deck to flybridge.
23. Two steps down to dive/swim platform.
24. Cockpit lockers for storage.
25. TV on Aft Deck **NEW 2023**
26. 2 side boarding doors
27. Second location bases for aft. deck table
28. S/S transom door with Horizon Logo
29. Dimmer switch for Aft. deck ceiling lighting

#### **Swimming Platform Area**

30. Built-in shower with hot/cold water.
31. Swim ladder on STBD side.
32. S/S safety rail on swim platform

Generated On 5/21/2023 12:55 PM by Richard Ford

Proud Member of 

**The Powercat Company LLC**  
**2525 Marina Bay Drive West**  
**Suite 202**  
**Fort Lauderdale Florida**  
**33312 United States**

**Richard Ford**  
**P: 9548038102**  
**M: 954 803 8102**  
**richard@powercatco.com**  
**www.horizonpowercatamarans.com**

**CUT AND RUN**

## Light

33. LED courtesy lights.
34. LED bulwark w/ flush mounted deck lights
35. LED ceiling lights
36. LED white light with 24VDC transformer on Horizon group logo in P&S.
37. Wiring for boat name on transom.
38. AQUA SIGNAL navigation lights.
39. Cockpit down lights.

## C. Flybridge:

1. Non-skid flybridge cambered deck with ample drainage.
2. Flybridge Carpet
3. Three Fixed Glass Front Windscreens with 1 x Washer/Wiper
4. Seacrylic side and Aft Enclosures
5. Flybridge Fully Airconditioned
6. Built in BBQ **NEW APRIL 2023**
7. Helm station with stainless wheel and instrument console.
8. Single STIDD helm chair
9. FRP Arch & FRP Hardtop.
10. Wet bar package:
  - FRP module bar with sink, with hot and cold water.
  - DC fridge in bar. **NEW 2023**
11. FRP table with seating.
12. Sunning bed/ Bench Seat stb side of helm console with cushions
13. Ample locker space for storage.
14. ES1000 Steelhead Crane **REBUILT 2023**
15. Covers for F/B Seating and console
16. Covers for aft deck seating, aft deck table and flybridge Table

## E. Engine Room and Equipments:

1. Sound and heat insulated compartments
2. Delta -T Moisture eliminators for engine rooms.
3. DC 24Volt lights.
4. One AC outlet.

## F. Electrical system:

### General

1. Color-coded wiring for easy identification.
2. Premium DC distribution board with switches, voltmeter and amp meter.
3. Outlets in Salon / bar / galley / cabins / fly-bridge / aft deck / engine room.
4. Vimar switches for lights and electrical outlets.

### AC/DC Main Power System

5. AC power supply from generator / shore power.
6. Selector switch for AC power supply.
7. Remote panel for generator.
8. Four AGM Batteries for engine & generator start up. **Replaced 2021**
9. Two AGM Batteries for ship's service power. **Replaced 2021**
10. BEP battery switch.

Generated On 5/21/2023 12:55 PM by Richard Ford

Proud Member of 

**The Powercat Company LLC**  
**2525 Marina Bay Drive West**  
**Suite 202**  
**Fort Lauderdale Florida**  
**33312 United States**

**Richard Ford**  
**P: 9548038102**  
**M: 954 803 8102**  
**richard@powercatco.com**  
**www.horizonpowercatamarans.com**

**CUT AND RUN**

11. One battery charger for all batteries.
12. One inverter 3.0 KW.
13. Premium AC panel with switches

#### **Shore Power System**

14. Glendenning shore power 50Amp connector with 100ft cord.

### **G. Mechanical system:**

#### **Fuel and Lube Oil System**

1. Dual Racor 900FG filters for both engines.
2. One oil change pump for engines, generator and Gearboxes.

#### **Fresh Water System**

3. 270 Gal of water tank integral to hull.
4. Color coded piping for easy identification.
5. Marine grade lines for fresh water system
6. One 17 Gal/110V or 220V water heater.
7. 2 x High volume 24V fresh water pump with accumulator tank.
8. Fresh water washdown for anchor.
9. Fresh Water Washdown on Aft Deck.

#### **10. Sanitary System**

11. 2 x 30 Gal of holding tank integral to hull
12. Electric fresh water flush toilets, pumps with Y valve for automatic discharge. and dock side pump out (2).

#### **Bilge Water System**

13. 4x electric 24V bilge pumps.
14. High level bilge water alarm.

#### **Fire Safety System**

15. One Seafire automatic/manual fire extinguisher in each engine room.

#### **Air Conditioning System**

16. Marine Air –air conditioning for salon. **NEW APRIL 2023**
17. Marine Air - air conditioning for VIP **NEW APRIL 2023**
18. **New Electrosea Airconditioning Cleaner System Oct 2022**
19. Hyd. Trim tab system

### **H. Interior Design and Equipment:**

#### **Interior Finish**

1. HardWood flooring.
2. Tempered safety glass windows.
3. Soft furnishings including roman blinds and accent wood finishing.

#### **Heads and Showers General**

4. Wood floor.
5. Corian countertops.
6. Fabric blind over large window.
7. Portlights for ventilation.
8. Basin, cabinets and mirrors.
9. Walk-in separate shower.
10. Linen Cupboard inboard of the M/S shower.
11. Separate toilet.
12. Lights in Overhead.
13. Extractor fan.

#### **Saloon**

14. Salon seating covered in fabric.
15. Cabinet for Crystal Glasses.
16. 42" TV in Salon.
17. Two hatches with screen on top of salon roof

#### **Galley/ Dinette**

18. Wood floor.
19. Carporee Counter tops.
20. Sub Zero 700TCI with Icemaker
21. Double sinks with tap.
22. Custom accent wood carpentry.
23. Custom wooden carpentry for galley, cupboards and counters.
24. Cutlery & crockery drawers.
25. Pot drawer & spice drawers.
26. Additional storage drawers and cupboards.
27. Under counter trash drawer.
28. Fischer Paykel Dishwasher

#### **VIP stateroom:**

29. Queen bed, semi walk around.
30. Custom wood accent carpentry.
31. Carpeted floor
32. Deck hatch with screen & opening.
33. Fabric blind over large window.
34. Soft furnishings.
35. Night stands with light switches and outlets.

#### **Port Aft guest stateroom:**

36. Custom wood accent carpentry.
37. Carpeted floor.
38. Opening port lights in hull side.
39. Soft furnishings.
40. Twin Bunks with insert Queen size Bed
41. Storage beneath bed.
42. Cabin lights.
43. Shared bathroom with VIP cabin.

#### **Master Stateroom**

44. Custom carpentry for accent finishing.
45. Carpeted floor.
46. Deck hatch with screen & opening.
47. Fabric blinds over large window
48. Queen size bed, semi walk around.
49. Large full height closets.
50. Closets for linens / towels and clothes.
51. Cabin lights.
52. Night stands with light switches and outlets.

#### **Galley**

53. GE- 4 burner Elec. cook top.
54. Extractor over cooktop.
55. GE Microwave / Convection oven. **NEW 2023**
56. Sub Zero 700TCI refrigerator w/ freezer and Icemaker.

#### **I. Navigation & Instrumentation: & Audio Video Equipment:**

1. 2 x Garmin 8215 15" touch screen chart plotter with GPS antenna on Flybridge.
2. Garmin Auto pilot.
3. AIS
4. Garmin GMR 404 4ft open array 48 mile radar.
5. 2 x Garmin GSD 26 Depth transducers.
6. Additional GM120 display
7. Garmin VHF 200 on flybridge.
8. Garmin XM weather and Radio.
9. Sunshin Spotlight on Flybridge
10. Fusion UD750 Stereo on Flybridge
11. Sirius XM Module and Antenna
12. Fusion 51600 Amp
13. JL Audio Sub woofer & 4 x 7" JL Audio Speakers on Flybridge
14. Sonos Connect on Flybridge
15. Sonos Connect on Aft Deck with 2 x 7" JL Audio Speakers
16. Sonos Connect on Bow with 2 x 7" JL Audio Speakers
17. Sonos Playbar in Salon with 2 x Play 1 speakers and Sub woofer
18. Cisco Linksys router in Salon
19. Sonos Playbar in Master Cabin
20. 48" Samsung LED TV in Salon
21. 32" Samsung LED TV in Master
22. 32" Samsung LED TV in VIP
23. KVH HD7 Satellite TV with Dummy Dome
24. Apple TV in all Cabins
25. Bluray in Salon and Master
26. Sat TV displays on Flybridge Garmin
27. Cradlepoint Cellular Internet

#### **I. Additional Equipment:**

1. Aft Deck Sun Awning
2. Bow Deck Cushions
3. Flybridge Clear Enclosure
4. 700 Gal/day Water-maker **Re-Built 2023**
5. New 5 Blade Veem Propellor **2022**
6. New Fusion Stereo Head **2022**







## Salon Looking Aft



**360 Degree View**



**Master Stateroom**

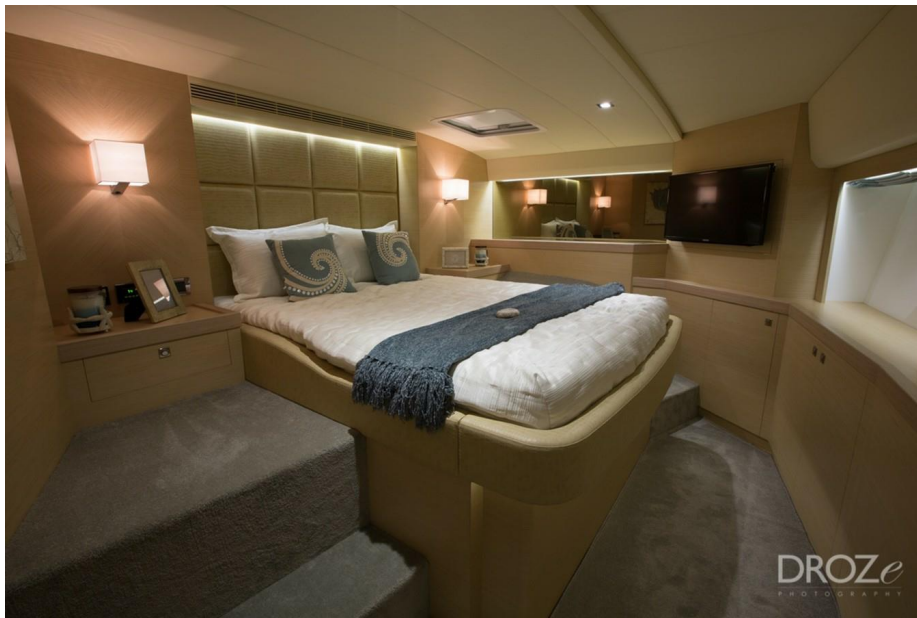

**Master Bathroom**



**VIP Stateroom**





## VIP Bathroom



## At Anchor



## Flybridge Deck



## Stern with Toys



### Aft Deck



### Sunbeds on Foredeck





## Profile



## Flybridge Layout

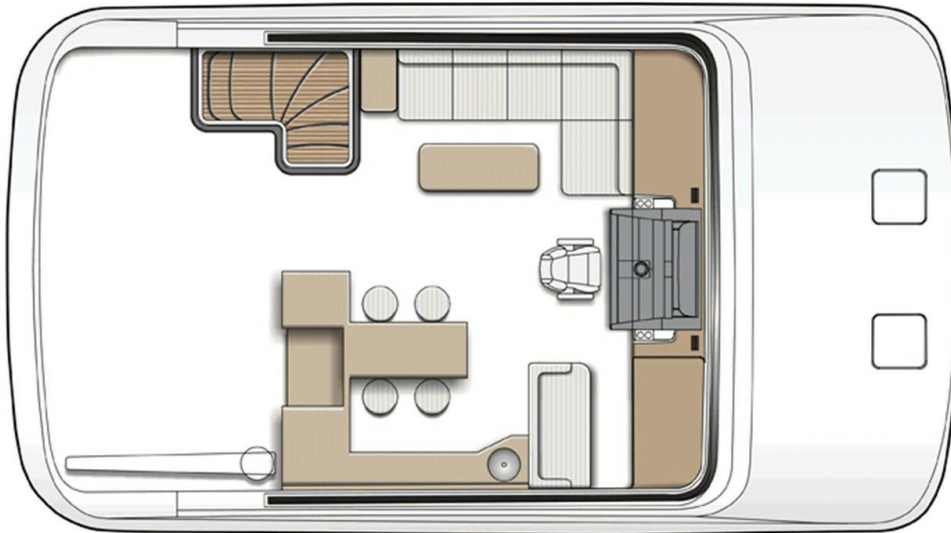



## Salon Layout

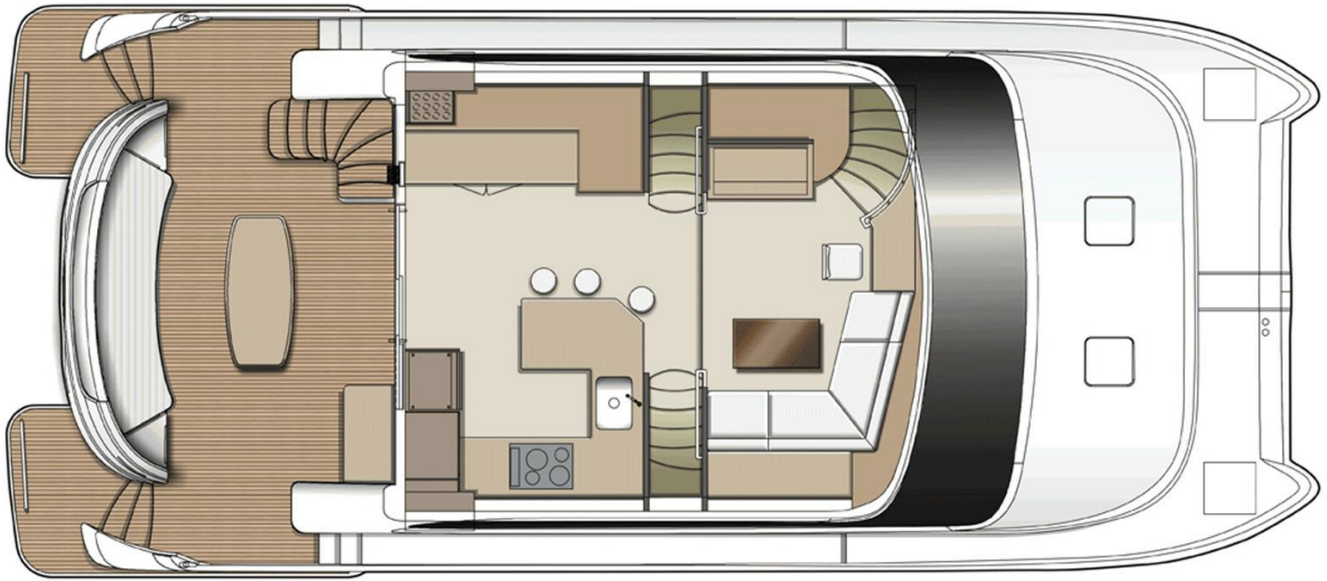

## Cabin Layout

